

BITUTHENE[®] PRIMER B2

Specially formulated primer for use with BITUTHENE[®] membranes and GCP underlayments on green concrete or damp substrates

Product Description

BITUTHENE[®] Primer B2 is a rubber-based primer in solvent specially formulated to provide good initial adhesion of BITUTHENE[®] waterproofing membranes and GCP underlayments. In addition, its patented formulation promotes the adhesion of BITUTHENE[®] membranes to green concrete and damp surfaces.

Product Use

BITUTHENE[®] Primer B2 is used to prime green concrete (less than seven day cure for normal structural concrete). It is also used to prime damp concrete, masonry or wood surfaces on which BITUTHENE[®] waterproofing membranes or GCP underlayments will be applied. BITUTHENE[®] Primer B2 is used for vertical and horizontal applications at -4 °C or above.

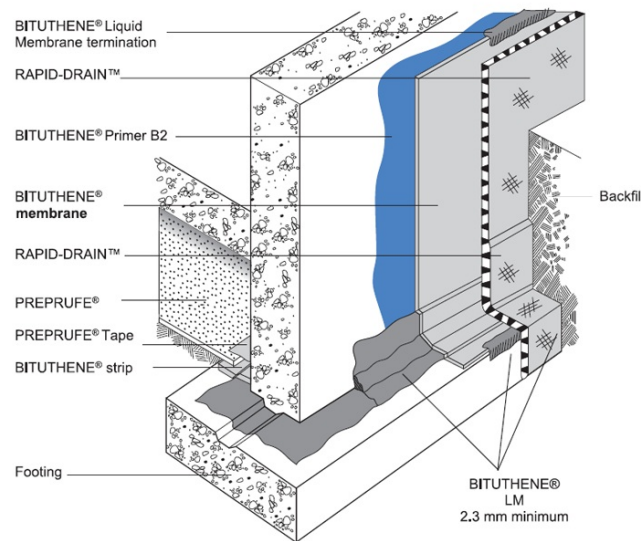

Drawings are for illustration purposes only.
Please refer to gcpat.com for specific application details.

Supply

BITUTHENE[®] PRIMER B2

Unit size	18.9 L pail
Weight	20 kg/pail
Units per pallet	48 pails
Coverage	6-8m ² /L

Application Procedures

Safety, Storage and Handling Information

BITUTHENE® products must be handled properly. Vapours from solvent-based primers and mastic are harmful and flammable GCP For these products, the best available information on safe handling, storage, personal protection, health and environmental considerations has been gathered. SDS (Safety Data Sheet) are available at gcpat.com and users should acquaint themselves with this information. Carefully read detailed precaution statements on product labels and the SDS before use.

Application

BITUTHENE® Primer B2 may be applied by roller or brush. Use a heavy nap roller made of natural material, such as lamb's wool. Apply it to clean, dirt free, frost-free surfaces at a coverage rate of 6–8 m²/L. Do not apply to frozen concrete or to areas with standing or visible water. Do not use during wet weather. Allow BITUTHENE® Primer B2 to dry one hour or until tack-free. Dry time may be longer in cold temperatures. Deep puddles of primer should be avoided as this will lengthen drying time. Rollers or brushes should be dipped into pans. Avoid pouring primer directly onto a horizontal substrate. Do not apply directly to BITUTHENE® membrane.

In general, priming should be limited to an area that can be covered with membrane within 24 hours. Areas that accumulate significant amounts of dust or dirt must be reprimed before membrane is applied.

Although it may be used on green concrete and damp surfaces, moisture may become trapped under the membrane. This may result in blistering, particularly on warm, sunny days. Therefore, cover the membrane, as soon as possible, to minimize blistering. If blistering occurs, allow membrane to cool and re-roll with heavy roller. Blisters over 100 mm in diameter should be cut and patched.

Clean tools with mineral spirits at the end of each day. Mineral spirits is a combustible liquid and should be used only in accordance with the manufacturer's safety recommendations. **Do not use solvents to clean hands or skin.**

Release Date: 02/11/18. The information contained in this product data sheet supersedes all previous versions.

gcpat.com.au | For technical information: anz.enq@gcpat.com

Australia 1800 334 444 email: au.sbmsales@gcpat.com New Zealand 0800 552 235 China Mainland +86 21 3158 2888 Hong Kong +852 2675 7898 India +91 124 488 5900 Indonesia +62 21 893 4260 Japan +81 3 5226 0231 Korea +82 32 820 0800 Malaysia +60 3 9074 6133 Philippines +63 49 549 7373 Singapore +65 6265 3033 Thailand +66 2 709 4470 Vietnam +84 8 3710 6168

We hope the information here will be helpful. It is based on data and knowledge considered to be true and accurate, and is offered for consideration, investigation and verification by the user, but we do not warrant the results to be obtained. Please read all statements, recommendations, and suggestions in conjunction with our conditions of sale, which apply to all goods supplied by us. No statement, recommendation, or suggestion is intended for any use that would infringe any patent, copyright, or other third party right.

BITUTHENE is a trademark, which may be registered in the United States and/or other countries, of GCP Applied Technologies, Inc. This trademark list has been compiled using available published information as of the publication date and may not accurately reflect current trademark ownership or status.

© Copyright 2019 GCP Applied Technologies, Inc. All rights reserved.

Printed in Australia GCP PDS 051 07/17

GCP Applied Technologies Inc., 2325 Lakeview Parkway, Alpharetta, GA 30009, USA

GCP Australia Pty. Ltd., 14 Colebard Street West, Archerfield, Brisbane, Queensland 4108, Australia

This document is only current as of the last updated date stated below and is valid only for use in Australia. It is important that you always refer to the currently available information at the URL below to provide the most current product information at the time of use. Additional literature such as Contractor Manuals, Technical Bulletins, Detail Drawings and detailing recommendations and other relevant documents are also available on www.gcpat.com.au. Information found on other websites must not be relied upon, as they may not be up-to-date or applicable to the conditions in your location and we do not accept any responsibility for their content. If there are any conflicts or if you need more information, please contact GCP Customer Service.

Last Updated: 2023-07-06

gcpat.com.au/solutions/products/bituthene-primer-b2