

FLORPRUFE[®] 120

Integrally bonded vapour protection for slabs on grade

Product Description

FLORPRUFE[®] 120 is a high-performance vapour barrier with GCP's Advanced Bond Technology™ that forms a unique seal to the underside of concrete floor slabs. Comprising a highly durable polyolefin sheet and a specially developed, non-tacky adhesive coating, FLORPRUFE 120 seals to liquid concrete to provide integrally bonded vapour protection. FLORPRUFE exceeds ASTM E1745 Class A rating.

Product Advantages

- Forms a powerful integral seal to the underside of concrete slabs
- Protects valuable floor finishes such as wood, tiles, carpet and resilient flooring from damage by vapour transmission
- Direct contact with the slab complies with the latest industry recommendations
- Remains sealed to the slab even in cases of ground settlement
- Ultra-low vapour permeability
- Durable, chemical resistant polyolefin sheet
- Lightweight, easy to apply, kick out rolls
- Simple lap forming with tapped laps

Use

FLORPRUFE 120 is engineered for use below slabs on grade with moisture-impermeable or moisture-sensitive floor finishes that require the highest level of vapour protection.

FLORPRUFE complies with the latest recommendations of ACI Committees 302 and 360, i.e. for slabs with vapour sensitive coverings, the location of the vapour barrier should always be in direct contact with the slab.

The membrane is loose laid onto the prepared sub-base. Selvege and end laps are fixed and permanently sealed using self-adhesive PREPRUFE[®] Tape. The unique bond of FLORPRUFE and PREPRUFE Tape to concrete provides continuity of vapour protection.

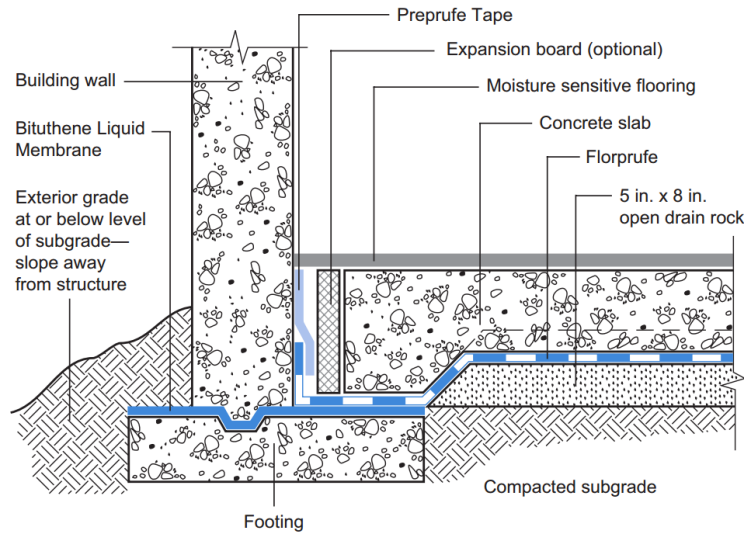

Slab reinforcement and concrete can be placed immediately. Once the concrete is poured, an integral bond develops between the concrete and membrane.

Installation

FLORPRUFE 120 can be applied at temperatures of -4°C or above. Do not install PREPRUFE Tape to wet FLORPRUFE 120.

Installation and detailing of FLORPRUFE 120 are generally in accordance with ASTM E1643-98.

Prepare substrate in accordance with ACI 302.1R Section 4.1. Install FLORPRUFE 120 over the levelled and compacted base. Place the membrane with the smooth side down and the plastic release liner side up facing towards the concrete slab. Remove and discard plastic release liner. End laps should be staggered to avoid a build-up of layers. Succeeding sheets should be accurately positioned to overlap the previous sheet 50 mm along the marked lap line.

Laps

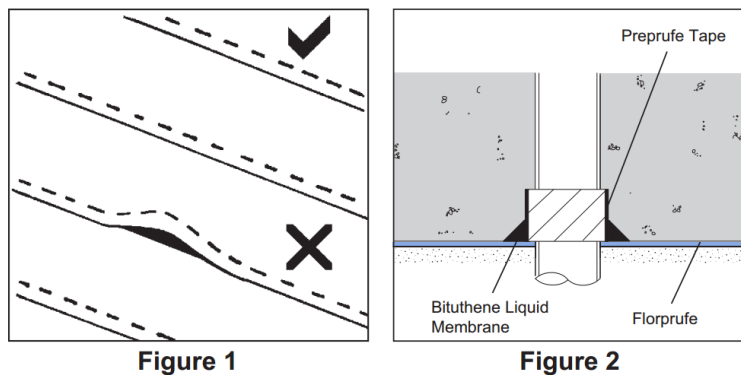

Figure 1

Figure 2

Use PREPRUFE Tape to secure and seal selvage overlaps, using the printed lap line for alignment and to seal end laps. Remove plastic release liner from the PREPRUFE Tape to ensure bond to concrete.

Penetrations

Wrap around penetration with PREPRUFE Tape.

Mix and apply BITUTHENE[®] Liquid Membrane detailing compound as a minimum 20mm fillet to the penetration/ PREPRUFE Tape / FLORPRUFE 120 junction to seal around penetrations such as drainage pipes, etc.

Apply BITUTHENE Liquid Membrane at minimum 2.3mm thickness, 50mm onto PREPRUFE Tape and 75mm onto the FLORPRUFE 120. (See Figure 2 and refer to the BITUTHENE Liquid Membrane data sheet.)

Concrete Placement

Place concrete within 30 days. Inspect membrane and repair any damage with patches of PREPRUFE Tape. Ensure all liner is removed from membrane and tape before concreting.

Supply

FLORPRUFE[®] 120

Supplied in rolls	1.2 m x 35 m
Roll area	42 m ²
Roll weight	32 kg approx.

ANCILLARY PRODUCTS

PREPRUFE[®] Tape is packaged in cartons containing 4 rolls that are 100 mm x 15 m.

BITUTHENE[®] Liquid Membrane is supplied in 5.7 L pails.

Physical Properties: Exceeds ASTM E1745 Class A rating

PROPERTY	TYPICAL VALUE	TEST METHOD
Colour	White	
Thickness (nominal)	0.5 mm	ASTM D3767—method A
Water vapour permeance	0.03 perms (1.7 ng/Pa.s.m ²)	ASTM E96—method B*
Tensile strength	65 lbs/in (11.3 N/mm)	ASTM D882
Elongation	300%	ASTM D412
Puncture resistance	3300 grams	ASTM D1709
Peel adhesion to concrete	4 lbs/in (700 N/m)	ASTM D903

*. Test methods that comprise ASTM E1745 standard for vapour retarders

Health and Safety

Read and understand the product label and Safety Data Sheet (SDS) for each system component. All users should acquaint themselves with this information prior to working with the products and follow the precautionary statements. SDSs can be obtained by contacting your local GCP representative or office.

gcpat.com.au | Australia customer service: 1 800 855 525

We hope the information here will be helpful. It is based on data and knowledge considered to be true and accurate, and is offered for consideration, investigation and verification by the user, but we do not warrant the results to be obtained. Please read all statements, recommendations, and suggestions in conjunction with our conditions of sale, which apply to all goods supplied by us. No statement, recommendation, or suggestion is intended for any use that would infringe any patent, copyright, or other third party right.

BITUTHENE, FLORPRUFE, and PREPRUFE are trademarks, which may be registered in the United States and/or other countries, of GCP Applied Technologies, Inc. This trademark list has been compiled using available published information as of the publication date and may not accurately reflect current trademark ownership or status.

© Copyright 2021 GCP Applied Technologies, Inc. All rights reserved.

GCP Applied Technologies Inc., 62 Whittemore Avenue, Cambridge, MA 02140, USA

GCP Australia Pty. Ltd., 14 Colebard Street West, Archerfield, Brisbane, Queensland 4108, Australia

This document is only current as of the last updated date stated below and is valid only for use in Australia. It is important that you always refer to the currently available information at the URL below to provide the most current product information at the time of use. Additional literature such as Contractor Manuals, Technical Bulletins, Detail Drawings and detailing recommendations and other relevant documents are also available on www.gcpat.com.au. Information found on other websites must not be relied upon, as they may not be up-to-date or applicable to the conditions in your location and we do not accept any responsibility for their content. If there are any conflicts or if you need more information, please contact GCP Customer Service.

Last Updated: 2021-07-05

gcpat.com.au/solutions/products/florprufe-120